



SANERGY

PRODUCT GUIDE

HGL Series Isolator Switches

www.sanergy-electric.com



I. Overview

The HGL series isolator switch is mainly used in circuits with AC 50Hz, a rated voltage of 400V, and a rated current of up to 3150A. They are used for infrequently switching circuits on and off and for electrical isolation as an isolation switch.





Features I

The acceleration mechanism for the instantaneous release of spring energy storage enables fast switching (13.8 m/s), independent of the operating handle speed, improving arc extinguishing.



Features II

The shell, made of glass fiber reinforced unsaturated polyester resin, offers flame retardancy, dielectric properties, carbonization resistance, and impact resistance, suitable for harsh environments.

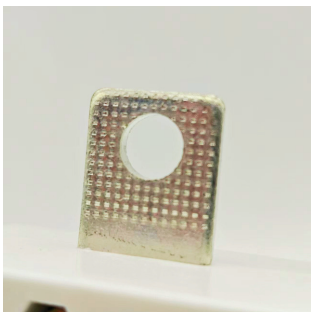

Features III

Parallel double breakpoint contacts are self-cleaning. All contacts have two separate faces. The large isolation distance in the "0" position allows for three locks to secure the handle, preventing misoperation.

III. Specifications

Basics	Model		ATOHGL-160A	
	Pole		3 Pole/4 Pole	
	Weight	3 Pole	1.2 kg	
4 Pole		1.4 kg		
Technical Parameters	Rated current		160A	
	Rated insulation voltage Ui		690V	
	Dielectric strength		1890V	
	Rated surge-resistant voltage Uimp kV (installed category IV)		8	
	Rated working current Ie	380V	AC-21	160A
			AC-22	160A
			AC-23	160A
		660V	AC-21	160A
			AC-22	160A
			DC-23	80A
		220V	DC-21	160A
			DC-22	160A
			DC-23	125A
		440V	DC-21	125A
			DC-22	125A
			DC-23	125A
	Motor power P (380V) Kw		380V	80 Kw
		660V	75 kW	
Rated short-time withstand current Icw (kA rms)0.1s/ 1.0s		12		
Rated breaking capacity Icm (Arms) AC23 380VA		1600		
Rated making capacity Icm (Arms) AC23 380V		2500		
Rated short-current making capacity Icm' (Kapeak value)		17		
Mechanical durability (number of cyclic operation)		10000		
Electric durability Ue=660V, Rated current		COSφ=0.95AC21	1700	
		COSφ=0.65AC22	100	
		COSφ=0.35AC23	500	
Working Environment	Moment of operation		1.2 Nm	
	Temperature		-5°C→+55°C	
	Way of working		Continuously working	
	Operating		Handle	
	Installation form		Vertical	
	Altitude		≤2000m	
	Pollution level		3	
	Overvoltage level		III	
	IP level		IP 20	

IV. Dimensions

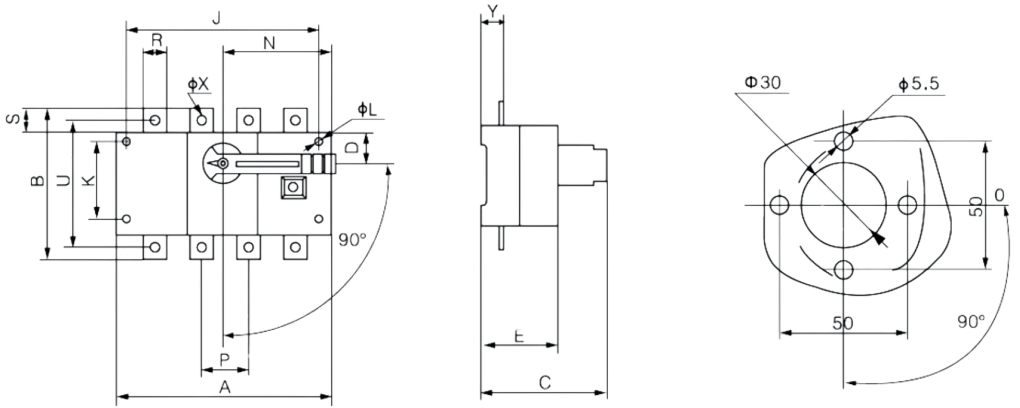

Current	A	B	C	D	D1	E	ΦL	J	K	N	P	R	S	U	ΦX	Y	F	H
160A/3P	140	135	121	27	93	71	5.5	120	65	75	36	20	25	115	9	24	50	10
160A/4P	170	135	121	27	93	71	5.5	150	65	75	36	20	25	115	9	24	50	10

V. Operation Mode

Bottom board used for installing the observing window
 Installing bottom board used for operation outside the board

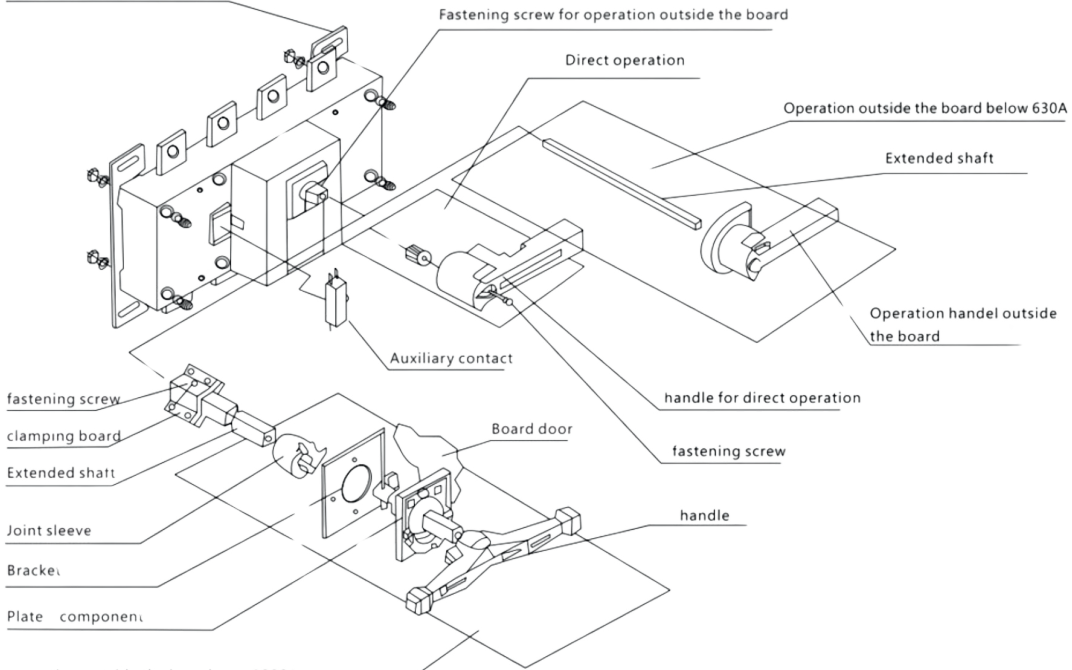

operation outside the board over 1000A
 HGL-160~315A Load Isolation switch

VI. Details

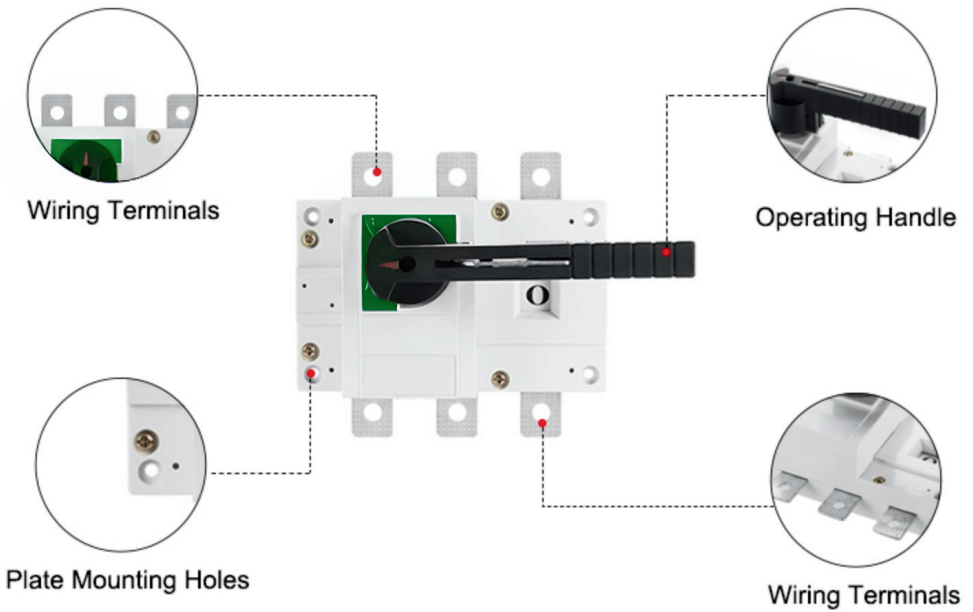

VII. Maintenance

Maintenance

The function of the isolating switch is crucial, as any failure can cause significant inconvenience to daily work and production. Therefore, regular maintenance is essential. For instance, you should frequently inspect the equipment's surface for weak or damaged parts. In special environments, the isolation switch may experience deformation and oxidation, necessitating timely replacement if the damage is severe. Heating at the contact points is common and can be due to various reasons, sometimes requiring power outage maintenance.

SANERGY

**Your Electrical Journey
Begins Here**

Thank you for exploring our collection. Each piece is crafted with passion and precision.

www.sanergy-electric.com